

SCALE IN FEET

E A R T H  T E C H

1420 KING STREET SUITE 600, ALEXANDRIA, VIRGINIA 22314

FIGURE 3-3A  
 SUITABLE PROPERTY FOR TRANSFER MAP  
 UMATILLA ARMY DEPOT ACTIVITY  
 HERMISTON , OREGON

DRAWN BY: MTM,LCB	DESIGNED BY: N/A	SCALE: 1" = 175'
CHECKED BY: GC	APPROVED BY: TH	DATE: 12/23/94
TETC PROJECT NUMBER 949002-04	DRAWING NUMBER SHEET <u>1</u> OF <u>1</u>	REV. NO. 0

REVISION	DATE
0	12/23/94



- Installation Boundary
- - - Administration Area Bound
- + + + Railroad
- x - Fence
- Current or Former UST
- ▲ Current or Former AST
- CATEGORY 1 PROPERTY  
Property where no hazardous or POL storage/release has occurred
- ▨ CATEGORY 2 PROPERTY  
Hazardous substance or POL and/or historically stored; no remedial actions have been taken
- ▩ CATEGORY 3 PROPERTY  
Hazardous Substance or POL below action level
- ▧ CATEGORY 4 PROPERTY  
Hazardous substance or POL all remedial actions have been taken
- ▦ CATEGORY 5 PROPERTY  
Hazardous substance or POL not all remedial actions have been taken
- ⊙ CATEGORY 6 PROPERTY  
Hazardous substance or POL areas adequately evaluated; remedial actions have been taken
- CATEGORY 7 PROPERTY  
Areas unevaluated or requiring additional evaluation

NOTES: (1) Site, Area, and Plume boundaries and UST/AST locations are approximate.  
 (2) This map categorizes property based on storage and/or release of CERCLA hazardous substances and/or POL. It does not identify the presence of environmental conditions such as asbestos and lead-based paint containing structures, radionuclides, radon, or PCB containing equipment which may also affect the disposal and reuse of property. The presence of these conditions categorizes property as "CERFA qualified" and is shown in the Environmental Condition of Property Map, Figure 3-2 of the BCP.  
 (3) The entire ADA Area is presumed to have UXO present. The ROD for the ADA Area indicates that a UXO survey of the area will be conducted. In addition, the U. S. Army will conduct a UXO survey of Site 39 to address safety concerns.

Source: CERFA Report for Umatilla Depot Activity, Dec. 1993  
 Enhanced Preliminary Assessment for Umatilla Depot Activity, Vol. 3, April 1990

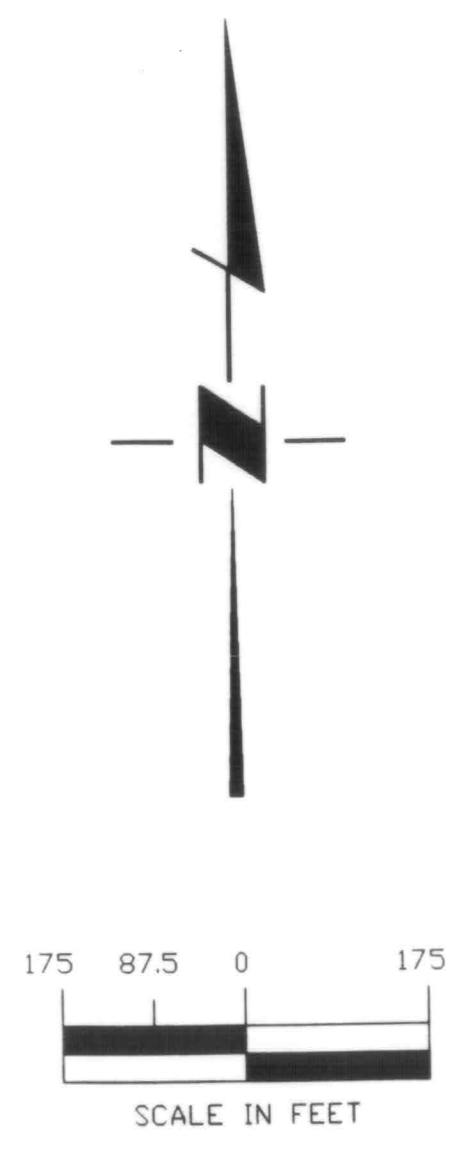

**EARTH T**  
 1420 KING STREET SUITE 600, ALEXANDRIA, VIRGINIA

FIGURE 3-3A  
 SUITABLE PROPERTY FOR TRASH  
 UMATILLA ARMY DEPOT ACTIVITY AREA  
 HERMISTON, OREGON

DRAWN BY: MTM,LCB	DESIGNED BY: N/A
CHECKED BY: GC	APPROVED BY: TH
ETC PROJECT NUMBER	DRAWING NUMBER
949002-04	SHEET 1 OF 1

REVISION	DATE
0	12/23/94

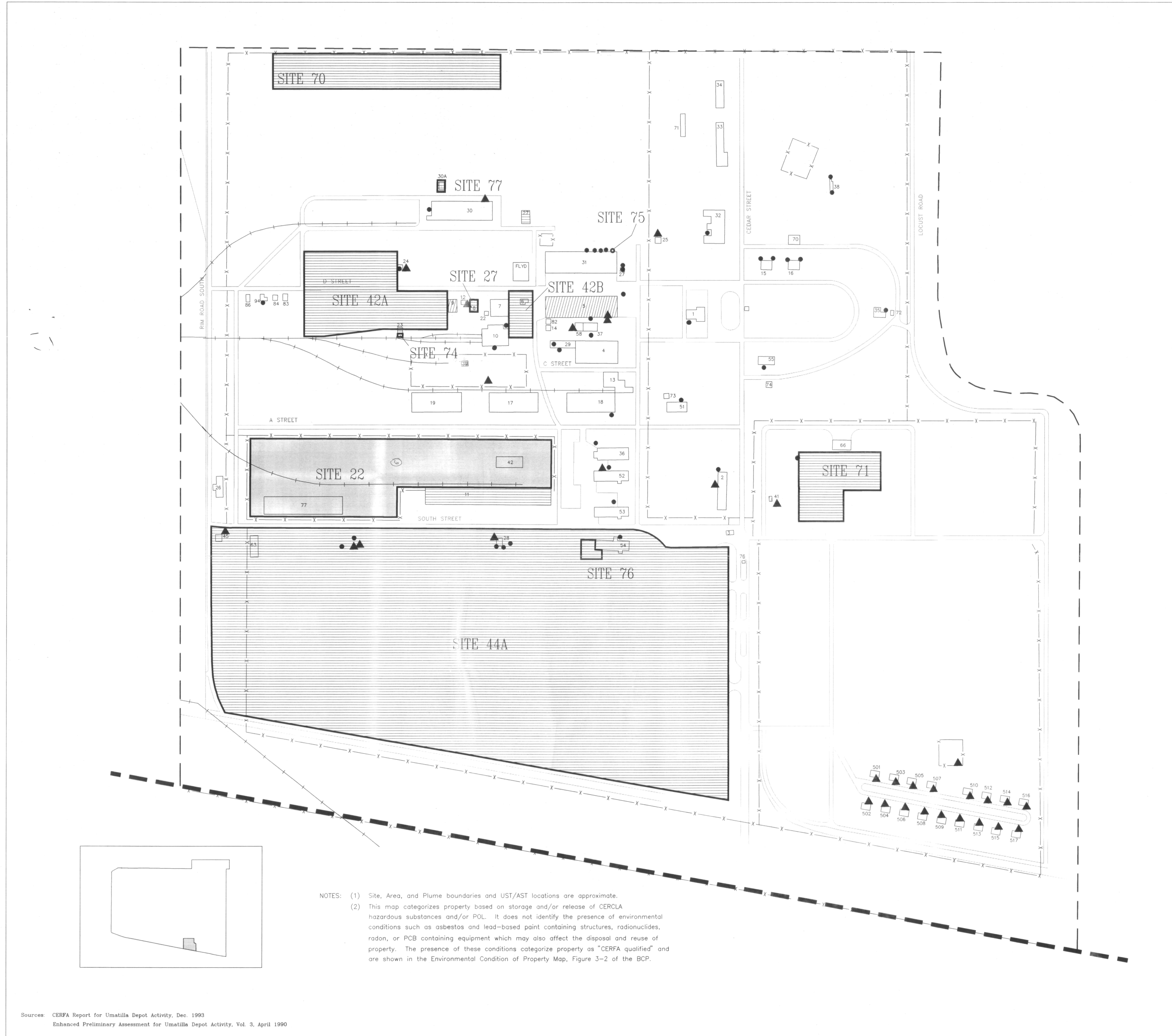

- Installation Boundary
- Administration Area Boundary
- Railroad
- x- Fence
- Current or Former UST
- ▲ Current or Former AST
- CATEGORY 1 PROPERTY  
Property where no hazardous substance  
POL storage/release has occurred
- ▨ CATEGORY 2 PROPERTY  
Hazardous substance or POL currently  
or historically stored; no release
- ▩ CATEGORY 3 PROPERTY  
Hazardous Substance or POL Release;  
below action level
- ▧ CATEGORY 4 PROPERTY  
Hazardous substance or POL release;  
all remedial actions have been taken
- ▦ CATEGORY 5 PROPERTY  
Hazardous substance or POL release;  
not all remedial actions have been taken
- ⊙ CATEGORY 6 PROPERTY  
Hazardous substance or POL release;  
areas adequately evaluated; no  
remedial actions have been taken
- CATEGORY 7 PROPERTY  
Areas unevaluated or requiring  
additional evaluation

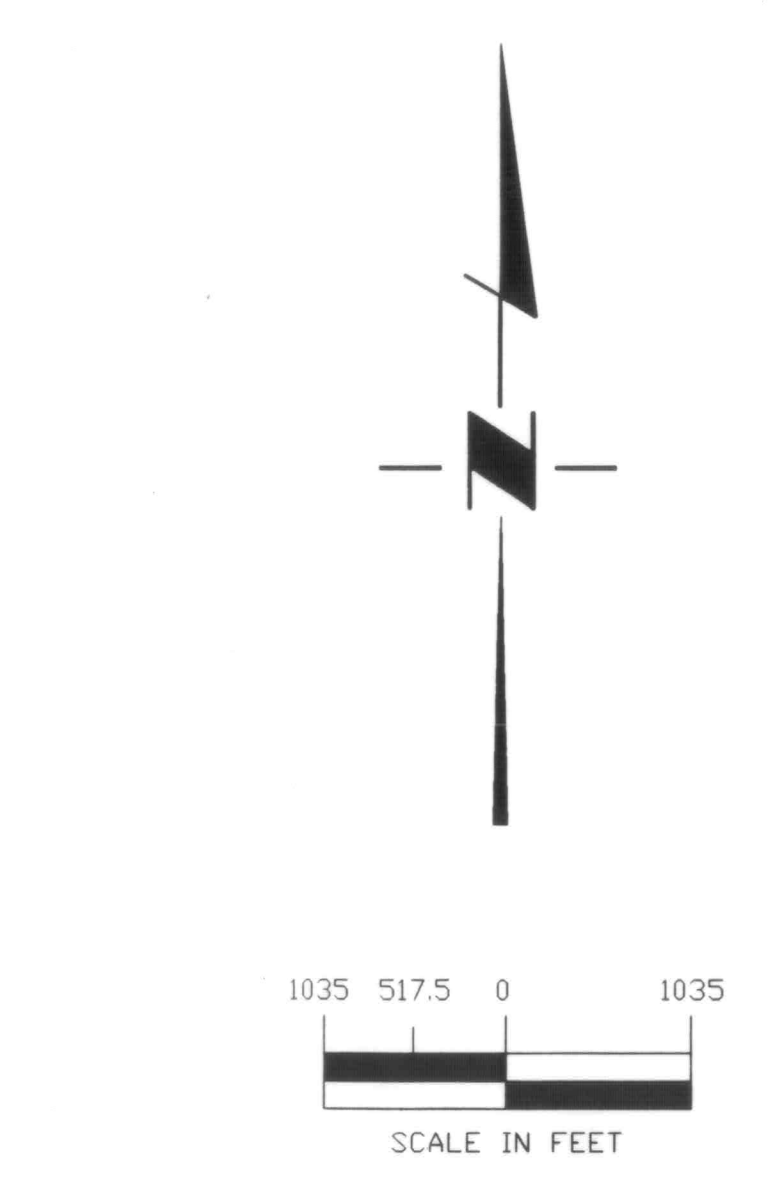

NOTES: (1) Site, Area, and Plume boundaries and UST/AST locations are approximate.  
 (2) This map categorizes property based on storage and/or release of CERCLA hazardous substances and/or POL. It does not identify the presence of environmental conditions such as asbestos and lead-based paint containing structures, radionuclides, radon, or PCB containing equipment which may also affect the disposal and reuse of property. The presence of these conditions categorize property as "CERFA qualified" and are shown in the Environmental Condition of Property Map, Figure 3-2 of the BCP.

Sources: CERFA Report for Umatilla Depot Activity, Dec. 1993  
 Enhanced Preliminary Assessment for Umatilla Depot Activity, Vol. 3, April 1990

<b>EARTHTECH</b>		
1420 KING STREET SUITE 600, ALEXANDRIA, VIRGINIA 22314		
FIGURE 3-3B SUITABLE PROPERTY FOR TRANSFER MAP UMATILLA ARMY DEPOT ACTIVITY ADMINISTRATION AREA HERMISTON, OREGON		
DRAWN BY: MTL/LCB	DESIGNED BY: N/A	SCALE: 1" = 1035'
CHECKED BY: GC	APPROVED BY: TH	DATE: 12/23/94
TEC PROJECT NUMBER: 949002-04	DRAWING NUMBER: SHEET 1 OF 1	REV. NO.: 0